

Roblee Hall



Originally known as North Hall, Roblee Hall began welcoming students in the early 1930s. North/Roblee was part of key expansion initiative of the College, and kicked off the development of what would become the North Residential Quad. It stands along College Ave.

All Roblee rooms are in suite configurations sharing a bathroom between them; all beds are standard twins. A limited number of rooms are air-conditioned.

There is an elevator located at the midpoint of the building. There is one enclosed stair tower at the midpoint of the west side of the building.

COMMON ROOMS

There are two main lounges adjacent to the main entrance at the east of the building, on the first floor.

Laundry facilities are located at the south end of each floor. (Remember laundry machines are free at Stephens!)

There is one kitchen on the first floor, on the west side of the main north/south corridor. It contains an electric range, fridge and microwave oven. There is an additional microwave located on each floor, with the exception of the first floor.



Roblee Hall: Floor Plans

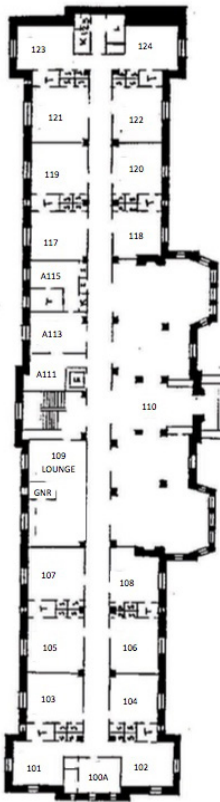

First Floor



Second Floor

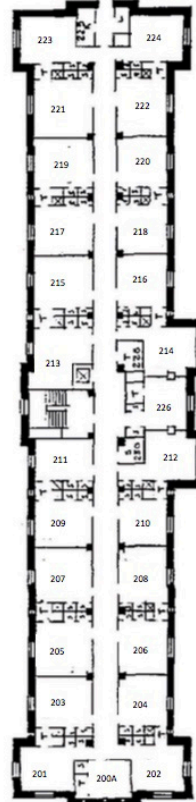

Third Floor



Fourth Floor

OFFICE OF RESIDENCE LIFE

Phone: (573) 876-7230, Ext. 4230 | Fax: (573) 876-7160
Campus Box: 2092 | Campus Location: 222 Stamper Commons
Email: reslife@stephens.edu