

Stephens College Campus

Parking Legend

| | |
|------------------|-----------|
| Student | S |
| Visitor | V |
| Faculty/Staff | FS |
| Loading Zone | LZ |
| Service Vehicles | SV |

Campus Key

- | | | |
|---|--|---|
| 1 Audrey Webb Child Study Center | 12 Historic Costume Gallery | 23 Sampson Hall |
| 2 Columbia Hall | 13 Hugh Stephens Resource Library | 24 Scene Shop |
| 3 Catharine Webb Studios | 14 John and Mary Silverthorne Arena | 25 Searcy Hall |
| 4 Davis Gallery | 15 Journey Religious Life Center | 26 Stamper Commons (including Windsor Lounge) |
| 5 Dudley Hall | 16 Lela Raney Wood Hall (including Kimball Ballroom and Stephens Administrative Offices) | 27 Stephens Stables |
| 6 E. S. Pillsbury Science Center | 17 Macklanburg Playhouse* | 28 Tower Hall |
| 7 Firestone Baars Chapel | 18 Maintenance Facility/Warehouse | 29 Visitors Center |
| 8 Greenhouse | 19 Pillsbury Hall | 30 Walter Hall |
| 9 Helis Communication Center (including Windsor Auditorium and Charters Lecture Hall) | 20 President's Home | 31 Warehouse Theatre |
| 10 Hickman Hall | 21 Prunty Hall | 32 Willis Court |
| 11 Historic Senior Hall | 22 Roblee Hall | 33 Wood Hall |

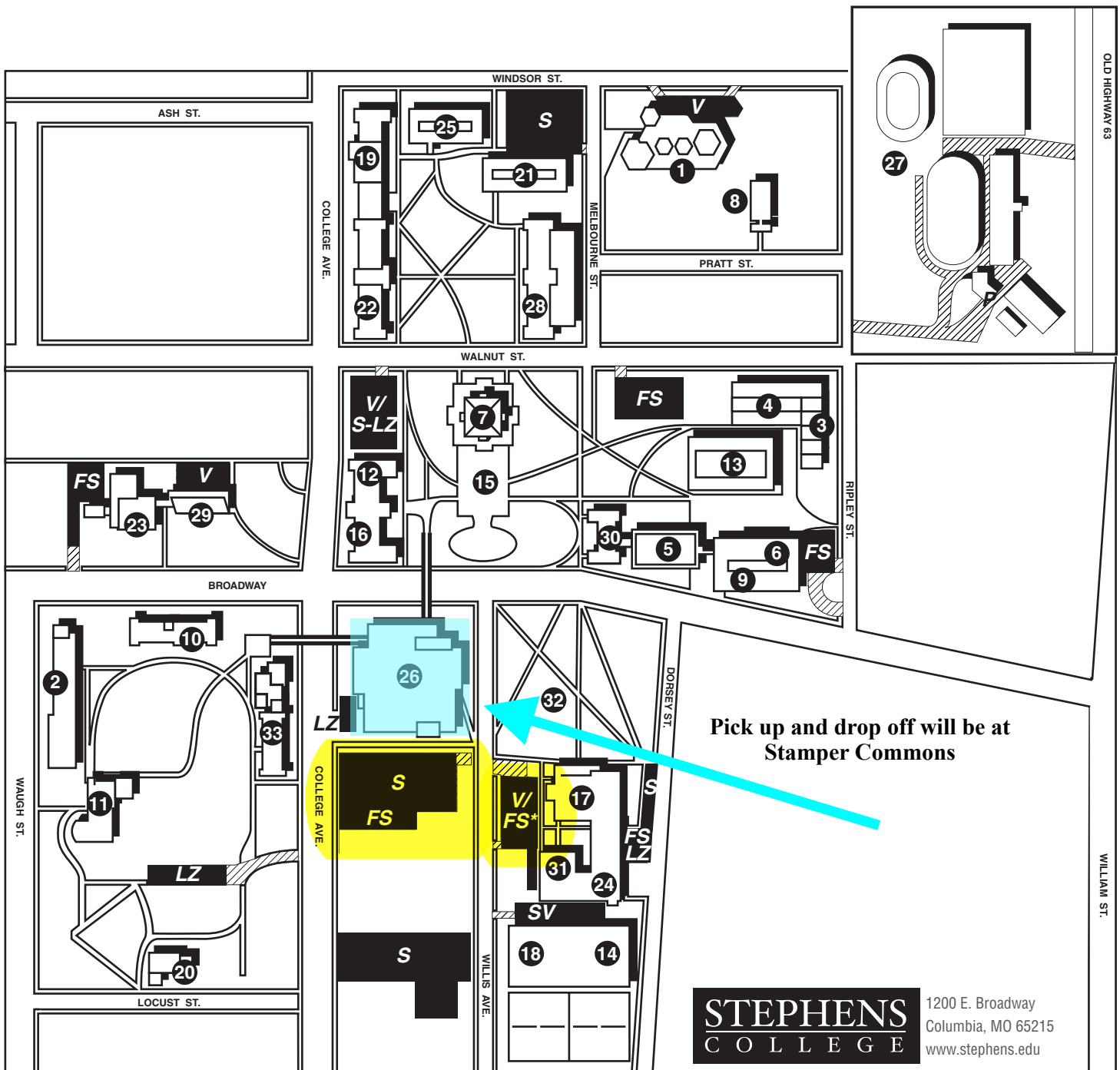

STEPHENS
COLLEGE

1200 E. Broadway
Columbia, MO 65215
www.stephens.edu

* Macklanburg Playhouse Lot = day: faculty and staff; evening: visitors